

TOPSTAR™

LED TUBE

Ballast Compatible
LED T8 Lamps

SHATTER-PROOF



Easily upgrade to LED from fluorescent.

Topstar Ballast Compatible LED T8 Lamps are an ideal energy saving choice for existing linear fluorescent fixtures.

Perfect for a wide range of applications

- Full light output in spaces with temperatures down to -4°F (-20°C)
- Perfect for applications with frequent "on/off" switching cycles
- Buildings that desire to be mercury free

Easy to experience

- Instant on, no flicker or buzz
- Fits into existing linear fixtures
- Optimized performance with Electronic Ballasts
- Eliminates the need for rewiring and allows the fixture to maintain original UL and CSA compliance
- Power Factor >0.9*
- THD <20%*

Material

- Glass tube with PET film coated

* Tested with typical ballast

Energy savings

- 50% energy savings vs F32T8 electronic instant start systems

Easy to experience

- No mercury allowing for non-hazardous waste disposal
- Emits virtually no UV rays or IR
- Ideal light emitting, building comfortable living, and working environment
- 5-year limited warranty

Low cost to retrofit

- Much labor cost is saved, because of easy replacement. Even one with little electrical experience, can achieve retrofit quickly and easily

1

TOPSTAR™

Electrical and Technical Data (subject to change without notice)

Ordering Code	Bare Lamp Watt (W)	Initial Lumen **	Base	CRI	Color Temp. *	Rated Average life	MOL (in.)	Beam Angle
● L24T8-8YY-09P-G4-EB	9	1400	G13	82	3000K/3500K/4000K/5000K	50.000	24	160
L36T8-8YY-10P-G4-EB	10	1300	G13	82	3000K/3500K/4000K/5000K	50.000	36	160
● L48T8-830-11P-G4-EB	11	1700	G13	82	3000K	50.000	48	160
● L48T8-8YY-11P-G4/G6-EB	11	1800	G13	82	3000K/3500K/4000K/5000K	50.000	48	160
● L48T8-835-12P-G4-EB	12	1800	G13	82	3500K	50.000	48	160
● L48T8-8YY-12P-G4-EB	12	1900	G13	82	3000K/3500K/4000K/5000K	50.000	48	160
● L48T8-8YY-14P-G4-EB	14	2200	G13	82	3000K/3500K/4000K/5000K	50.000	48	160

- This Lamp is DLC4.3 Listed
- * There is no inventory of 3000K in US.
- ** Initial Lumen is @ 4000K

Suitable for use in fixtures where ambient temperature is between -4°F (-20°C) and 113°F (45°C).

FCC Note: This device complies with Part 18 of the FCC Rules.

Installation Guide

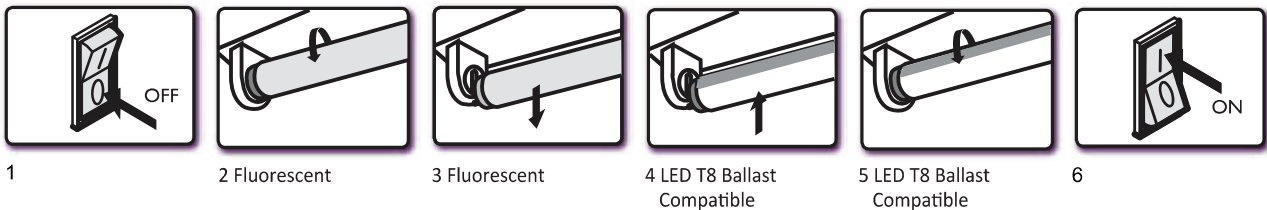

1. Switch-off power to the luminaire
2. Remove diffuser (if provided)
3. Remove the existing fluorescent lamps from the luminaire.
 - Note: Verify the fluorescent tube type is listed on the label of Wing LED T8 Ballast Compatible lamp.
- 4-5. Install the LED T8 Ballast Compatible lamp (One for each fluorescent lamp removed, ensure pins are firmly seated in lampholders).
 - Replace diffuser (if removed in step 2).
6. Switch on power to the luminaire.

CAUTION

- If the lamp or luminaire exhibits undesirable operation (buzzing, flickering, etc.), immediately turn off power, remove lamp from luminaire and contact the manufacturer
- Risk of Fire. Do not install in a pre-heat luminaire

WARNING

- Risk of fire, use only in place of fluorescent lamps specified on label. See instructions.

This lamp only operates on electronic ballasts. If lamp does not light when the luminaire is energized, remove lamp from luminaire and contact lamp manufacturer or qualified electrician.

This product may cause interference to radio equipment and should not be installed near maritime safety communications equipment or other critical navigation or communication equipment operating between 0.45-30 MHz.