

Installation and Instruction Manual

HOWARD[®]
LIGHTING PRODUCTS

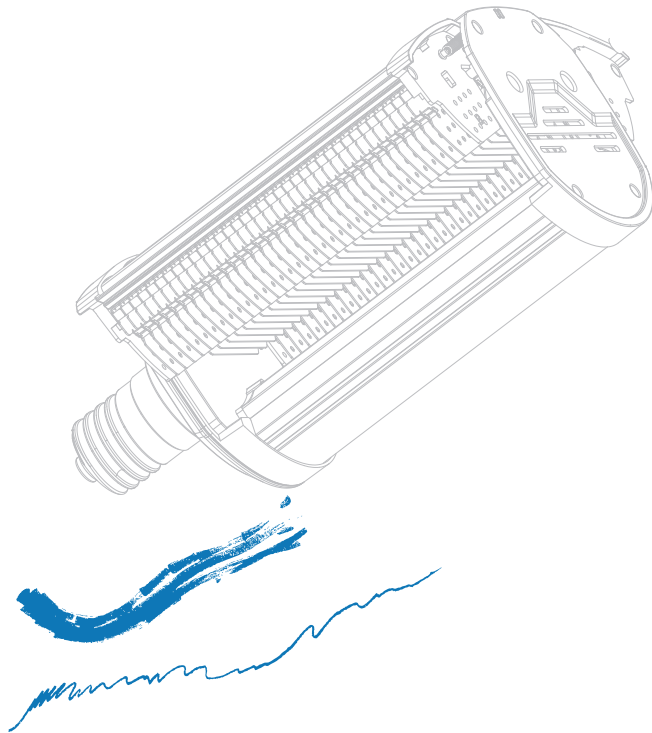

LEDMAR
80W/110W

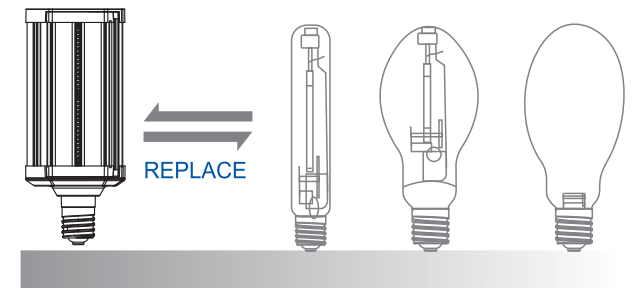

Installation and Instruction Manual

LED Retrofit Lamps

Please read the instructions carefully and observe installation details.

Applications

To be installed in interior enclosed or open and exterior enclosed luminaires. Replacing HID lamps in applications such as but not limited to: Shoe-box, Flood Light and Parking lot. This lamp wires directly to the line voltage. Do not connect this lamp to a ballast.

Replaces:

High Pressure Sodium, Metal Halide, Pulse Start Metal Halide, and Compact Fluorescent (HID, HPS, MH, PSMH, CFL)

Warning

1. Operating Temperature Range: -29~60 °C (-20~140 °F)
Storage Temperature Range: -20~40 °C (-4~104 °F).
2. This lamp must be installed by a qualified electrician. Install the lamp as per detailed instructions. Do not make any alterations to this lamp or add/remove any components.
3. Please ensure the electrical circuit is disconnected and safely locked out before attempting retrofit. Test and make sure the supply is OFF.
4. This lamp is not dimmable. Do not install this lamp with a dimming control.
5. Do not open or take apart the lamp. There are no user serviceable parts inside.
6. Do not stare directly at the light as this may cause injury to your eyes.
7. This device is not intended for use with emergency exits.
8. For use in open or enclosed luminaires. Min.lamp compartment dimensions (L) 9.85" x (W) 9.85".

1. Remove the existing ballast, capacitor, starter and lamp. Disconnect ballast from existing lamp holder. Remove and recycle the lamp and ballast components per local and national codes. Break connections as shown as Figure 1.

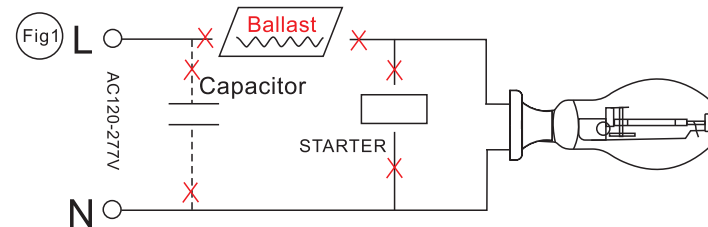

2. Connect Supply Line and Neutral directly to the existing lamp holder. Shown as Figure 2

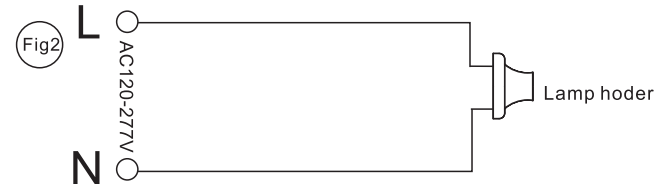

3. Install new LED Retrofit Lamp as shown as Figure 3. Please make sure the luminaire is properly grounded.

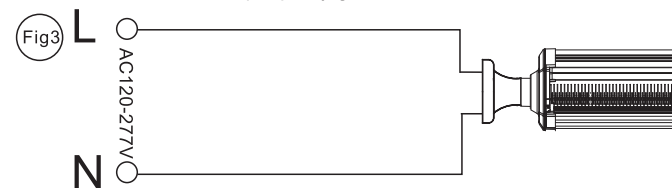

WARNING: THE LAMP WINGS MUST BE UNFOLDED COMPLETELY FOR THE LAMP TO OPERATE.

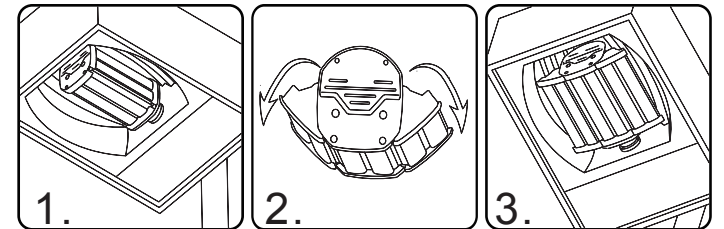

1. Screw lamp into fixture socket.
2. Adjust the lamp to achieve desired orientation. Unfold lamp wings completely.
3. Finish installation with mounting bracket.
4. Fix the acrylic stand onto the bottom of the lamp, cut off the excess part as shown in picture below:

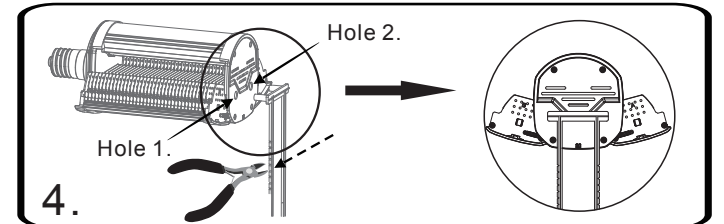

Warranty

5 year warranty based on the manufacture date code printed on the base of the lamp. If you have any questions please do not hesitate to contact Howard Lighting Products at 1-800-956-3456.